

**SS3000**

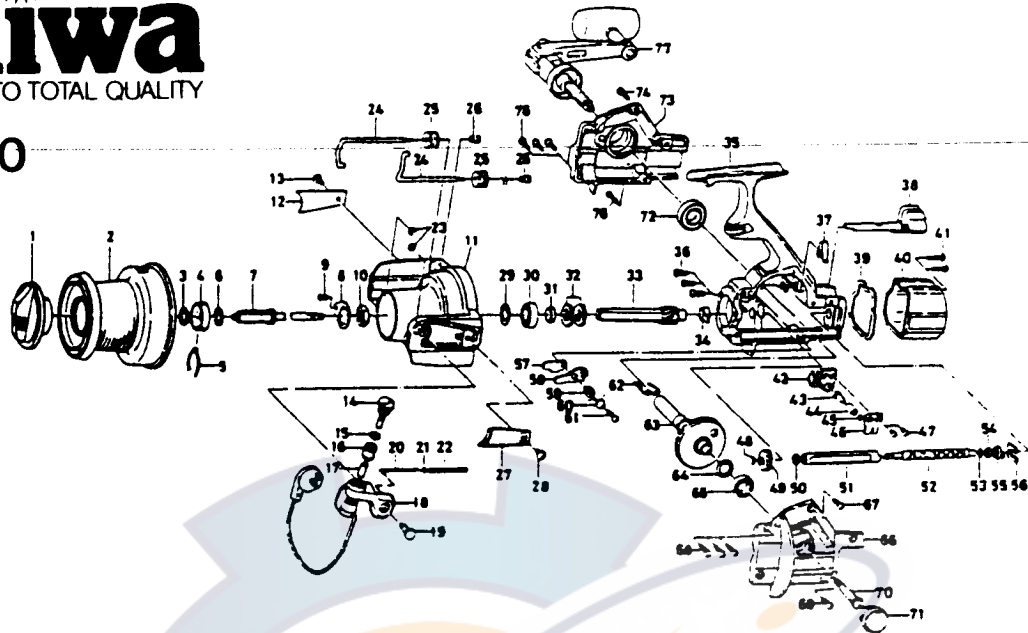

Key No.	Parts No.	Parts Name	Key No.	Parts No.	Parts Name
1.	E12-6801	Drag knob	42.	E26-3102	Oscillating slider
2.	E33-5001	Spool assembly	43.	E26-4101	Oscillating pawl
3.	E14-6503	Spool washer	44.	E26-4201	Oscillating pawl bush
4.	E12-2301	Click leaf spring holder	45.	375-0800	Oscillating pawl washer
5.	B74-7701	Spool click leaf spring	46.	E26-4301	Oscillating slider cover
6.	371-2800	Main shaft washer	47.	352-1502	Oscillating slider cover screw
7.	E33-3901	Main shaft assembly	48.	320-5901	Worm shaft gear retainer
8.	E33-3801	Rotor nut holding plate	49.	E26-3401	Worm shaft gear
9.	351-1003	Rotor nut holding plate screw	50.	E33-2501	Ball bearing B
10.	B43-7603	Rotor nut	51.	E33-2301	Worm shield cover
11.	E35-4301	Rotor assembly	52.	E33-2401	Worm shaft
12.	E33-3501	Bail trip cover	53.	B41-1700	Worm shaft washer
13.	351-6104	Bail trip cover screw	54.	E33-2501	Ball bearing B
14.	B21-1305	Line roller screw	55.	E33-2001	Worm shaft collar
15.	375-4301	Lock washer	56.	E26-3601	Worm shaft retainer
16.	E33-3601	Line roller	57.	E26-1901	Anti-reverse pawl plate
17.	B44-3401	Line roller bushing	58.	E26-2001	Anti-reverse pawl
18.	E33-3101	Bail	59.	E26-2101	Anti-reverse pawl collar
19.	E33-3401	Bail arm screw	60.	E26-2201	Anti-reverse pawl spring A
20.	E32-6701	Bail spring shaft	61.	B83-5002	Anti-reverse pawl screw
21.	E31-3901	Bail spring washer	62.	E26-4501	Anti-reverse pawl spring B
22.	E26-5601	Bail spring	63.	F00-4201	Drive gear
23.	320-5901	Bail arm screw retainer	64.	B27-0700	Drive gear washer
24.	E35-5601	Line guard roller shaft	65.	637-6101	Ball bearing A
25.	E32-6801	Line guard roller	66.	E33-2801	Left side cover
26.	E26-6901	Roller shaft nut	67.	B00-9702	Side cover screw A
27.	E33-3501	Bail spring cover	68.	B00-9701	Side cover screw B
28.	351-6104	Bail spring cover screw	69.	E15-8601	Side cover screw C
29.	B27-0704	Bearing washer	70.	B33-2501	Handle screw
30.	637-6101	Ball bearing A	71.	E33-4801	Handle screw cap
31.	E26-2801	Spacing sleeve	72.	637-6101	Ball bearing A
32.	E26-2701	Anti-reverse ratchet	73.	E33-2601	Right side cover
33.	E33-2201	Pinion gear	74.	B00-9702	Side cover screw A
34.	E33-2101	Pinion holder	75.	B00-9701	Side cover screw B
35.	E33-1404	Body	76.	E15-8601	Side cover screw C
36.	E03-7801	Bearing retainer screw	77.	E33-4501	Handle assembly
37.	E32-7801	Anti-reverse cam spring			
38.	E26-2302	Anti-reverse lever			
39.	E26-4801	Water shield			
40.	E33-4201	Rear cover			
41.	E24-8102	Rear cover screw			